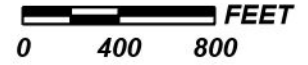
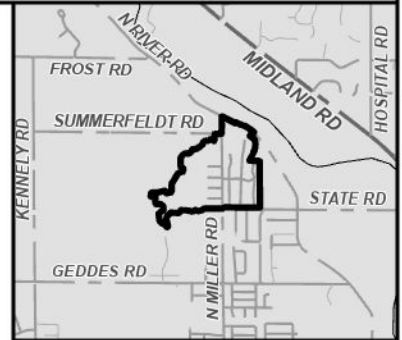
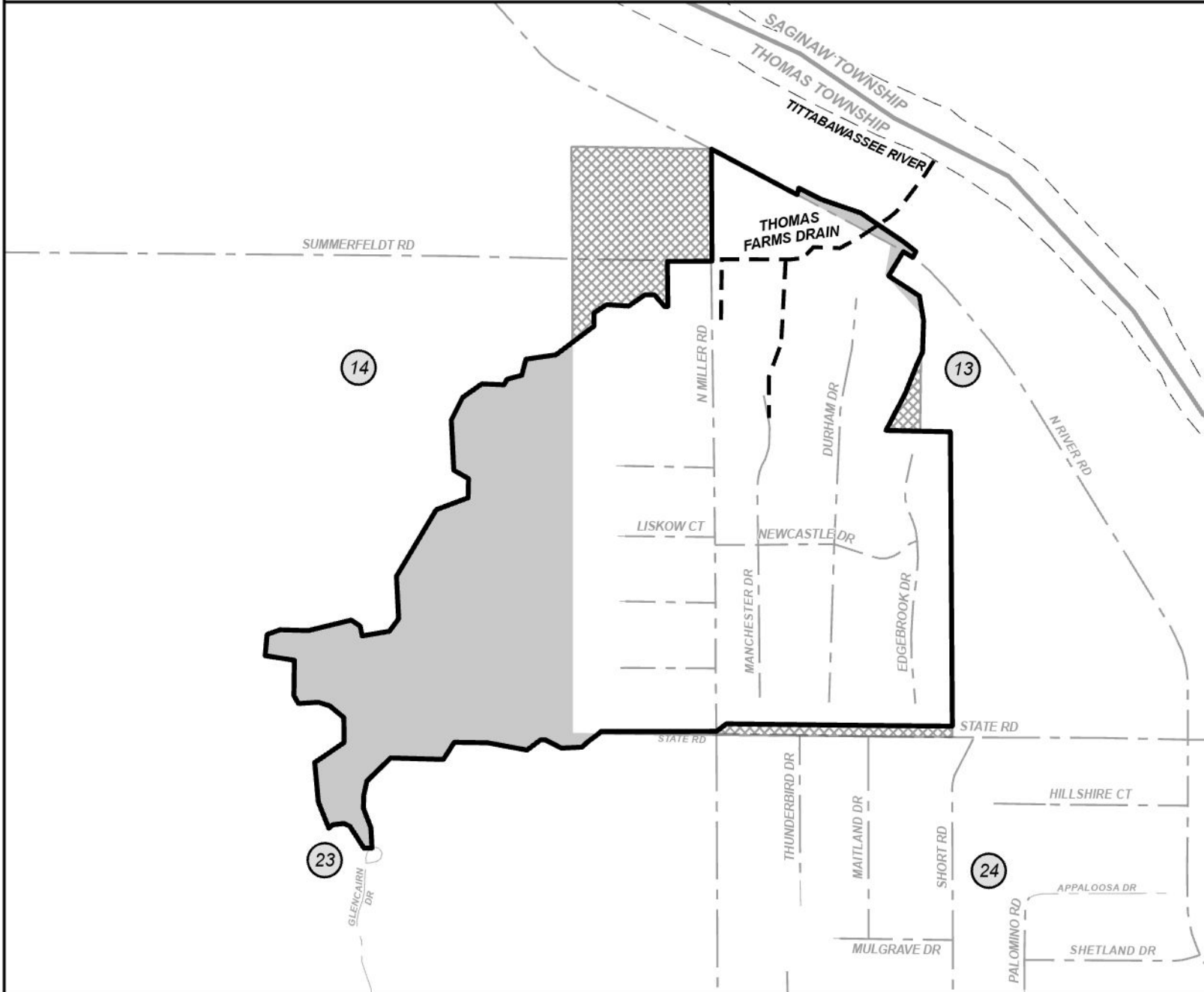

EXHIBIT "B1"
THOMAS FARMS DRAIN DRAINAGE DISTRICT
 SAGINAW COUNTY PUBLIC WORKS COMMISSIONER
 BRIAN J. WENDLING



LEGEND

- DRAINAGE DISTRICT BOUNDARY
- DRAIN
- OUTLET WATERCOURSE
- LANDS ADDED
- LANDS REMOVED
- MUNICIPALITY BOUNDARIES
- STATE ROADS
- COUNTY ROADS
- LOCAL ROADS
- RAILROAD