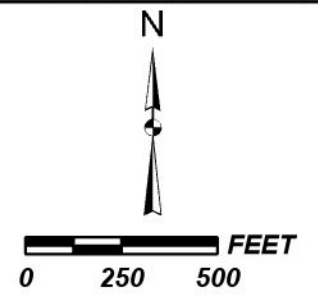
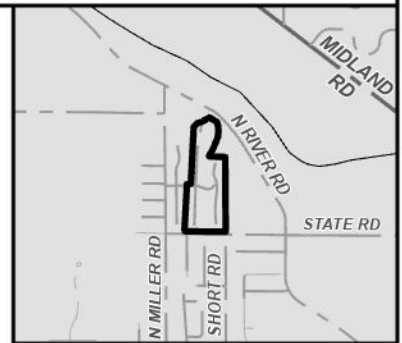
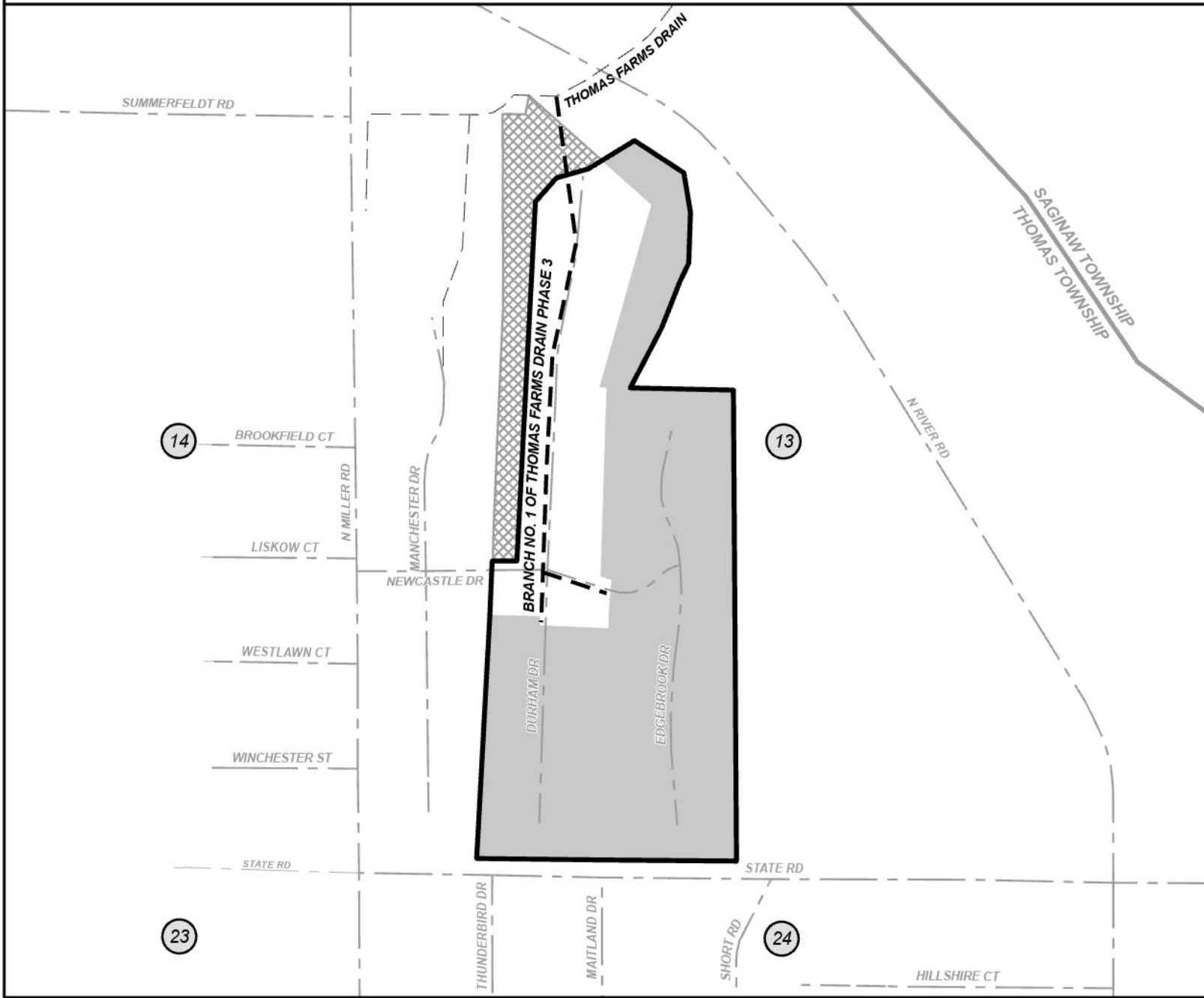

**EXHIBIT "B1"**  
**BRANCH NO. 1 OF THOMAS FARMS DRAIN PHASE 3 DRAINAGE DISTRICT**  
**SAGINAW COUNTY PUBLIC WORKS COMMISSIONER**  
**BRIAN J. WENDLING**



- LEGEND**
- DRAINAGE DISTRICT BOUNDARY
  - DRAIN
  - OUTLET WATERCOURSE
  - LANDS ADDED
  - LANDS REMOVED
  - MUNICIPALITY BOUNDARIES
  - STATE ROADS
  - COUNTY ROADS
  - LOCAL ROADS
  - RAILROAD