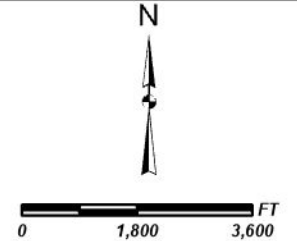
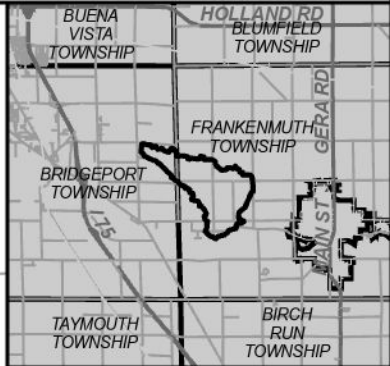
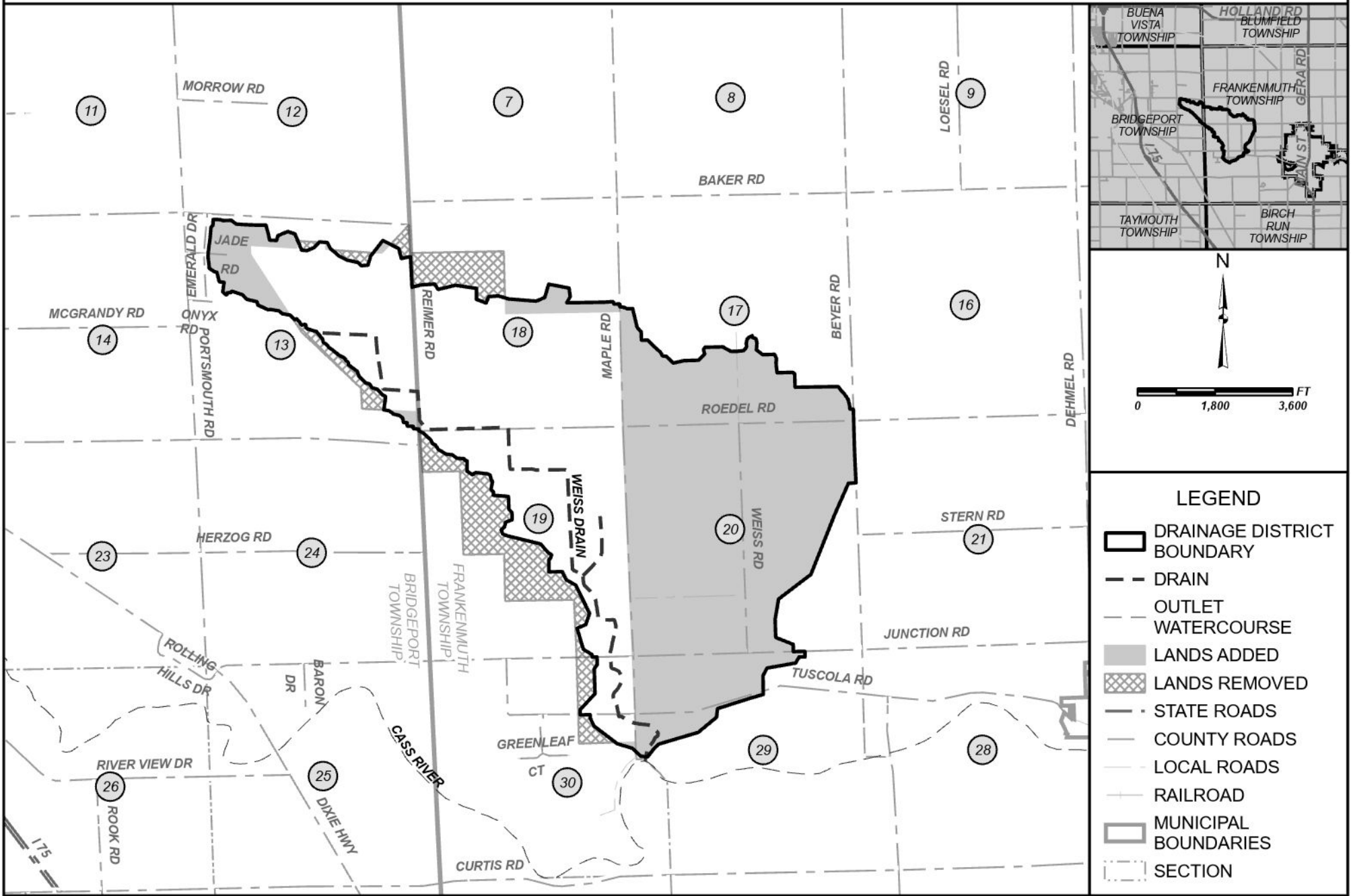

**EXHIBIT "B1"**  
**WEISS DRAIN DRAINAGE DISTRICT**  
 SAGINAW COUNTY PUBLIC WORKS COMMISSIONER- BRIAN J. WENDLING



- LEGEND**
- DRAINAGE DISTRICT BOUNDARY
  - DRAIN
  - OUTLET WATERCOURSE
  - LANDS ADDED
  - LANDS REMOVED
  - STATE ROADS
  - COUNTY ROADS
  - LOCAL ROADS
  - RAILROAD
  - MUNICIPAL BOUNDARIES
  - SECTION