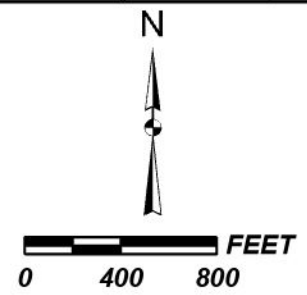
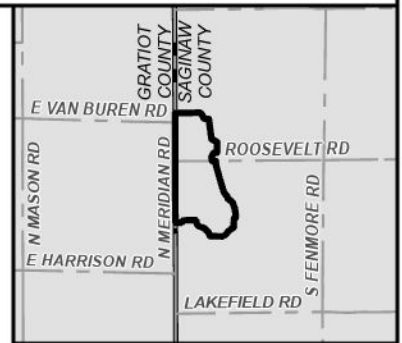
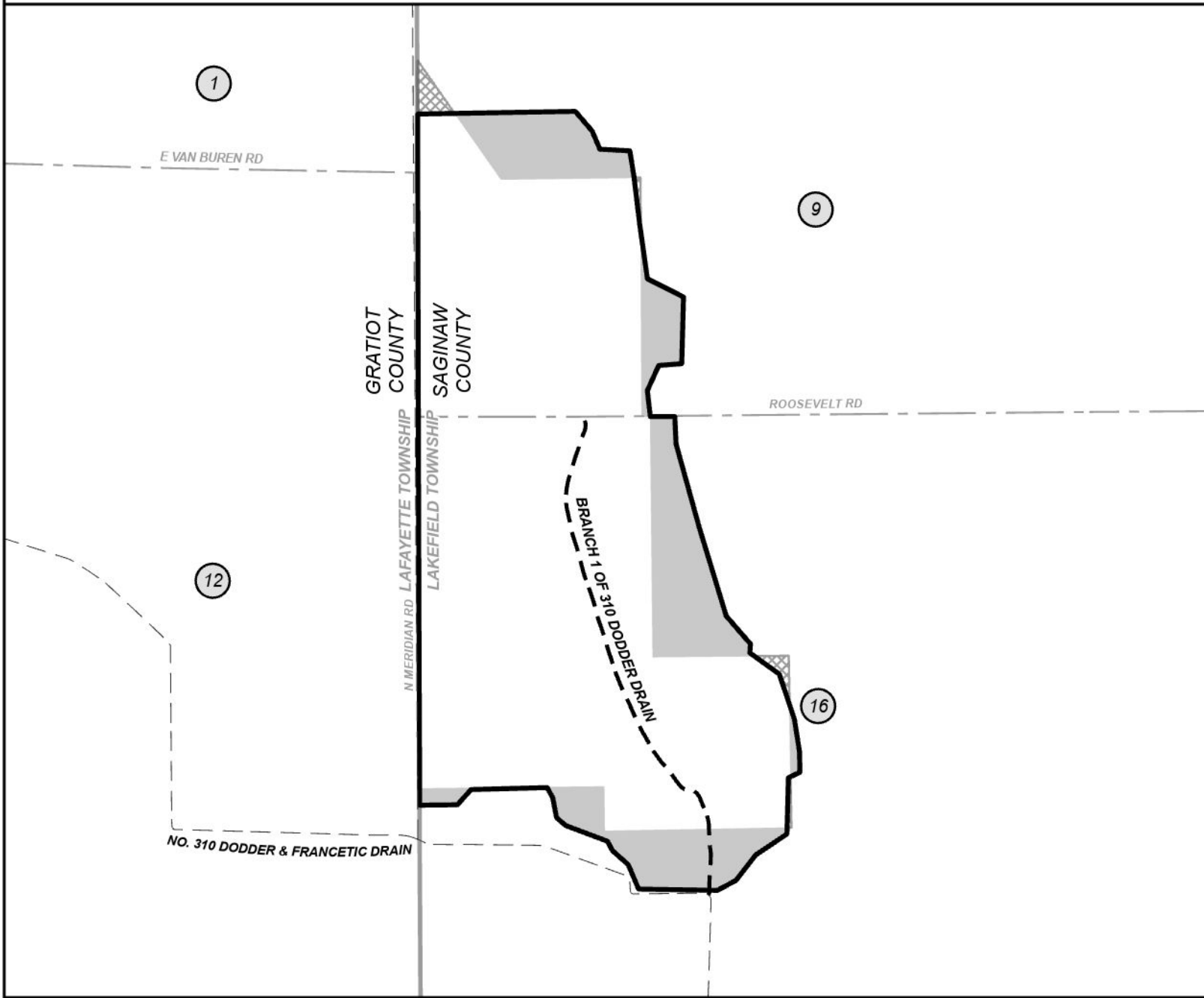

EXHIBIT "B1"
BRANCH 1 OF 310 DODDER DRAIN DRAINAGE DISTRICT
 SAGINAW COUNTY PUBLIC WORKS COMMISSIONER
 BRIAN J. WENDLING



- LEGEND**
- DRAINAGE DISTRICT BOUNDARY
 - DRAIN
 - OUTLET WATERCOURSE
 - LANDS ADDED
 - LANDS REMOVED
 - MUNICIPALITY BOUNDARIES
 - STATE ROADS
 - COUNTY ROADS
 - LOCAL ROADS
 - RAILROAD